

Bavaria 51 Cruiser "Attila"



From Bavaria;
Perfect sailing properties are the key to successful yacht design – and this is no different for the CRUISER 51. In her design lies the knowledge of hundreds of racing and cruising yachts, which gives her high speed potential while maintaining the safest possible seakeeping.

| Year of Build | | |
|---------------------------|-------------------|---------------|
| 2014 | | |
| Cabins | Berths | Showers/Heads |
| 5 | 10 | 3 |
| Cabin Layout | | |
| 4 Doubles + Twin + Saloon | | |
| Length [m] | Beam [m] | Draft [m] |
| 15.6 | 4.7 | 2.3 |
| Water [l] | Fuel [l] | Engine [HP] |
| 560 | 280 | 75 |
| Displacement [kg] | Sail Area [sq. m] | |
| 14100 | 131 | |

| Sails | |
|-----------------------------------|--|
| Furling Main Sail • Furling Genoa | |

| External Equipment |
|--|
| Bow Thruster • Electric Windlass • Bimini • Sprayhood • Teak Deck • Cockpit Table • External Shower • External Speakers • Dinghy • Full Safety Equipment |

| Internal Equipment |
|---|
| Shore Power • Inverter • Hot Water • Radio-CD Player • Fully Fitted Galley • Fridge |

| Navigation And Electronics |
|--|
| Speed - Wind - Depth • Autopilot • GPS Chart Plotter • VHF |

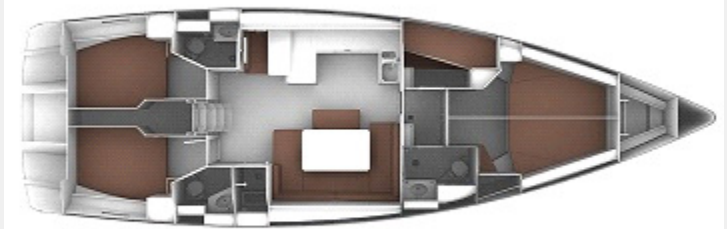

The CRUISER 51 has a spacious cockpit area, with comfortable seating and ergonomics that have been at the top of the designers' agenda. While the helmsman keeps the CRUISER 51 on course with an optimum view of the deck, sailing instruments and sails from both steering columns, the crew can enjoy the cruise from the newly designed cockpit table with its large side wings. Anything that does not belong on deck while sailing is stored in the large and spacious lockers and storage space under the cockpit floor

